

Notes:
 All CHS Sections are hot rolled, steel grade S355J2H
 All solid rods & RSA frames are steel grade S275JR
 All structural steelwork is hot dipped galvanised to: BS EN ISO 1461:2009

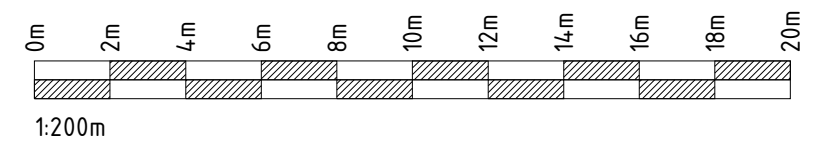

If Applicable : Ordnance Survey Ireland Licence No. EN 0001219 © Ordnance Survey Ireland and Government of Ireland

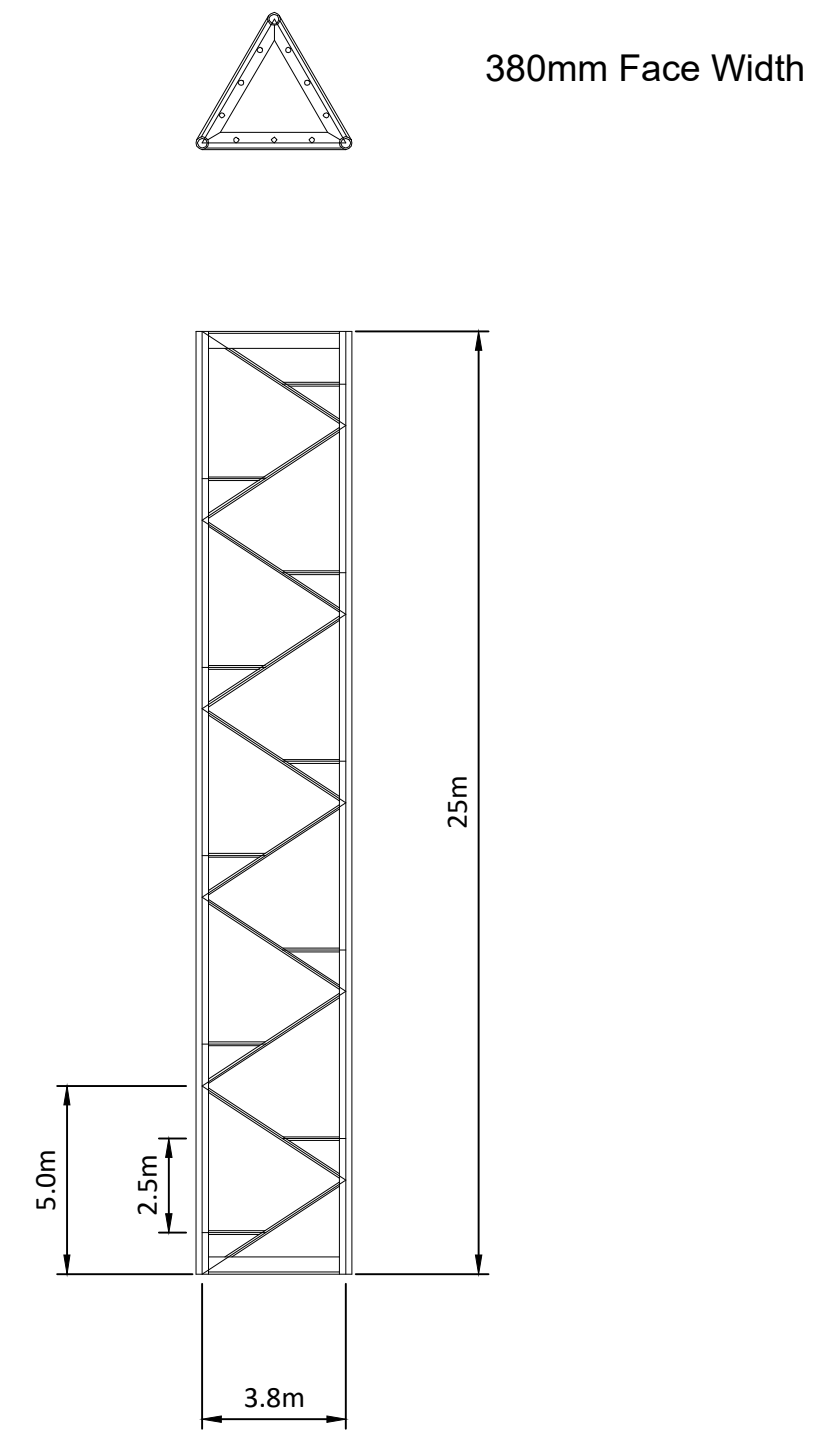
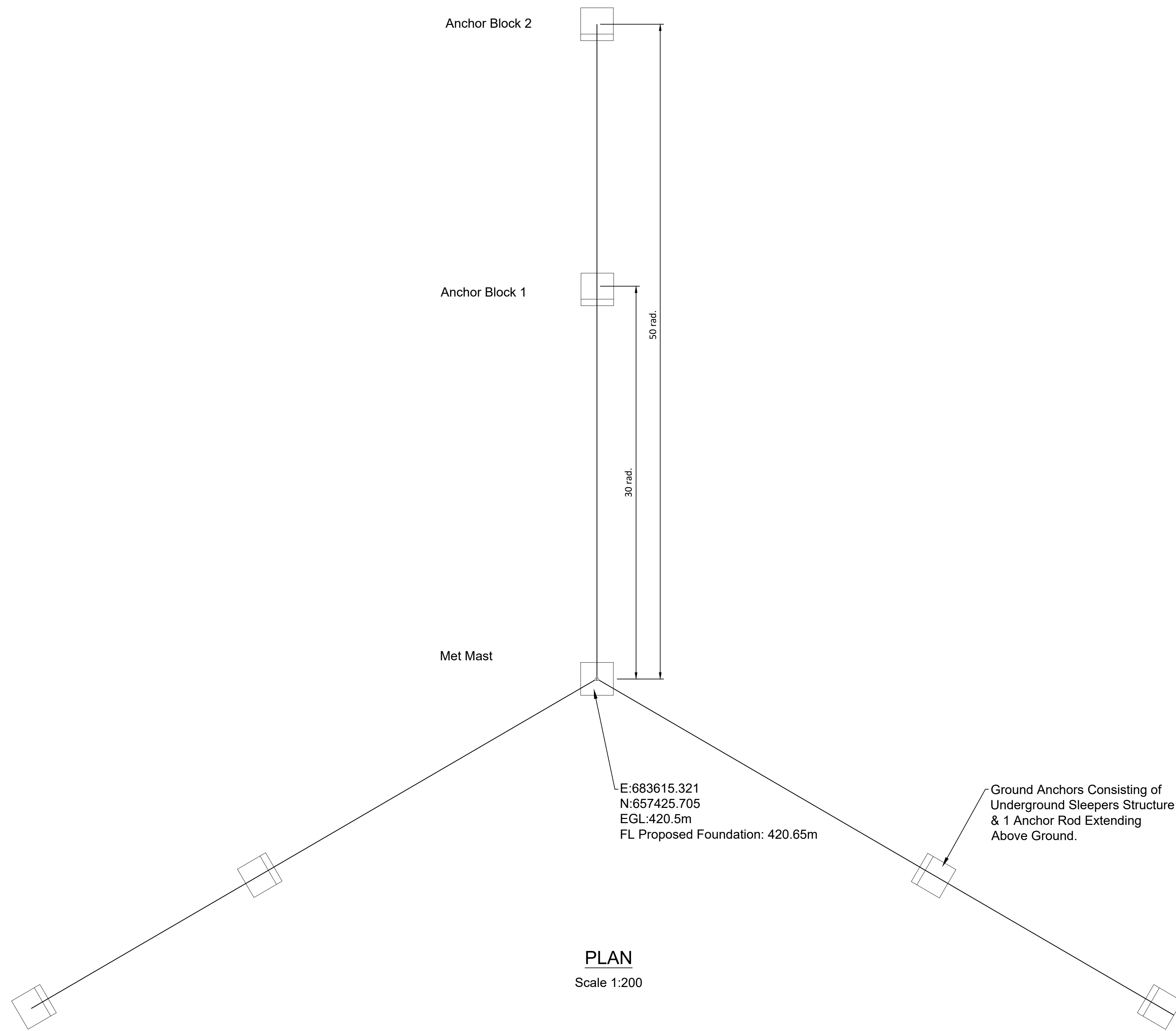

No part of this document may be reproduced or transmitted in any form or stored in any retrieval system of any nature without the written permission of Fehily Timoney & Company as copyright holder except as agreed for use on the project for which the document was originally issued. Do not scale. Use figured dimensions only. If in doubt - Ask!

Rev.	Description	App By	Date
A	ISSUE FOR APPROVAL	JH	20.11.20
B	ISSUE FOR GENERAL COMMENT FOR ALL DRAWINGS	JH	24.11.20
C	ISSUE FOR PLANNING	JH	11.12.20

PROJECT	CLIENT		
CROAGHAUN WIND FARM	COILLTE		
SHEET	Date	Project number	Scale (@ A1-)
100m MET MAST DETAILS SHEET 2 OF 2	20.11.20	P1913	1:200
	Drawn by	Drawing Number	Rev
	SOC	P1913-0300-0009	C
	Checked by		
	CL		

O:\ACAD\2019\P1913\P1913-0300-0009

20 January 2021